

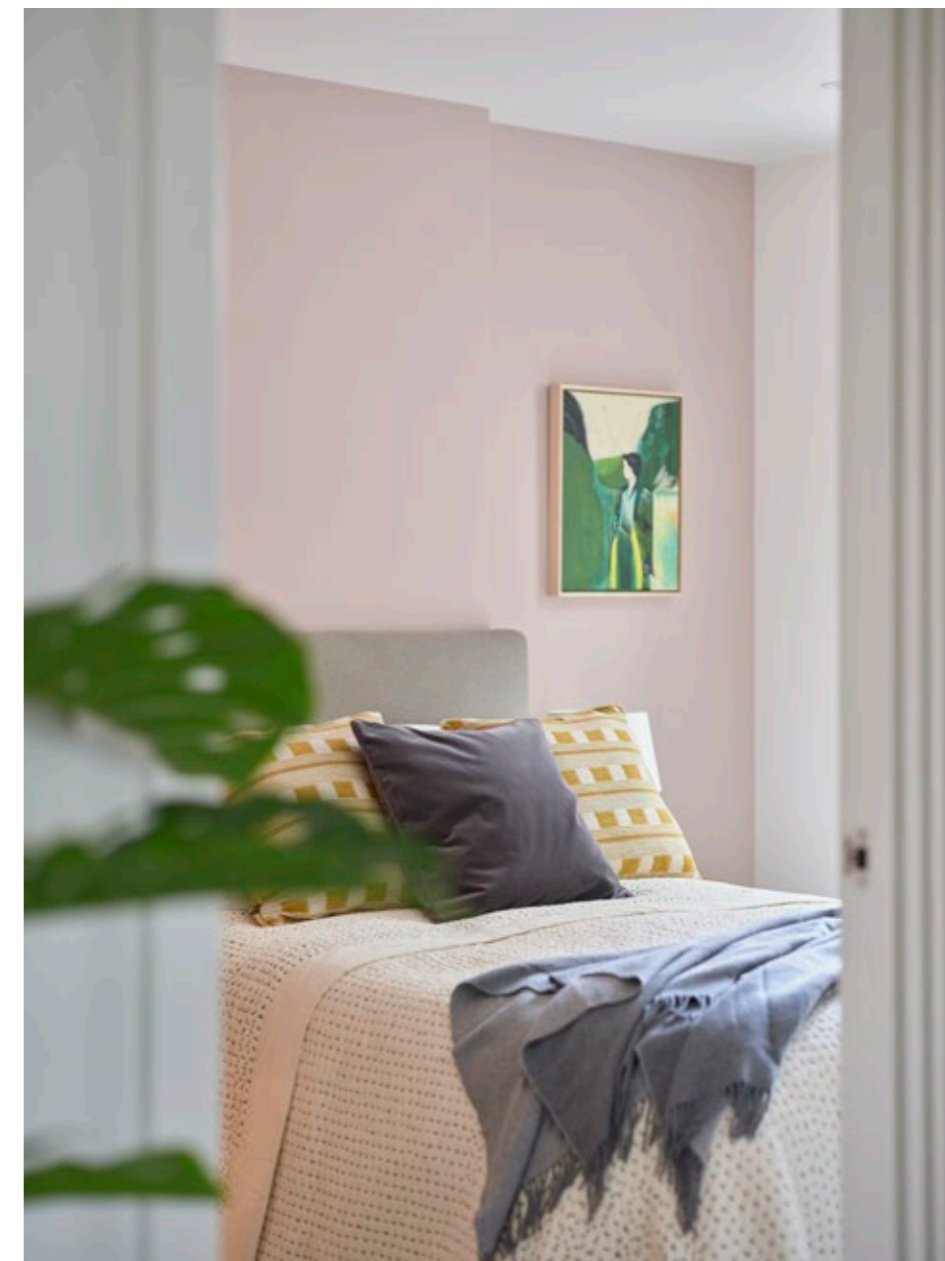

# APARTMENT 4-A



**NEW VIC**  
MANCHESTER



Our stunning apartments are available  
furnished or unfurnished.





3 BEDROOM

# APARTMENT TYPE 4-A

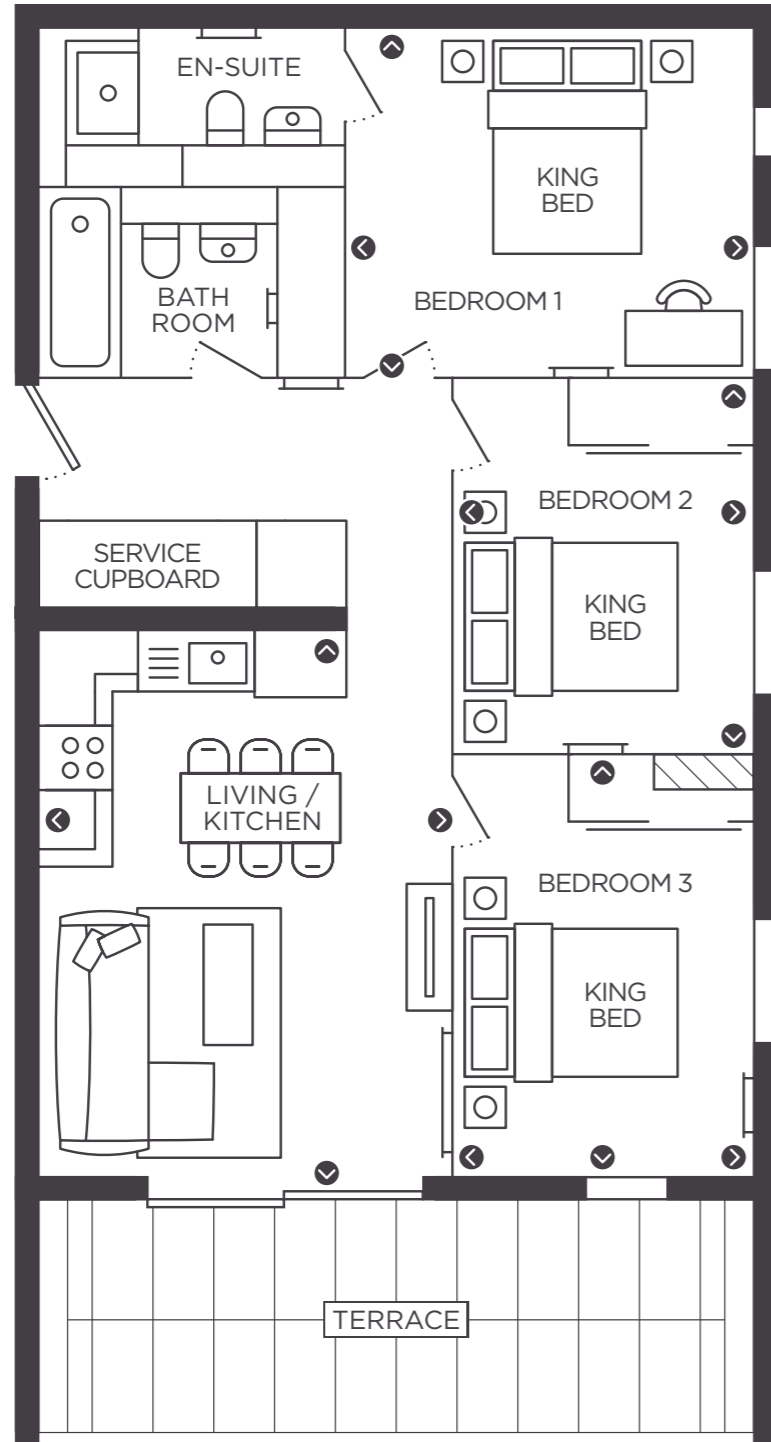

TOTAL

# 80.2 SQ M | 863 SQ FT

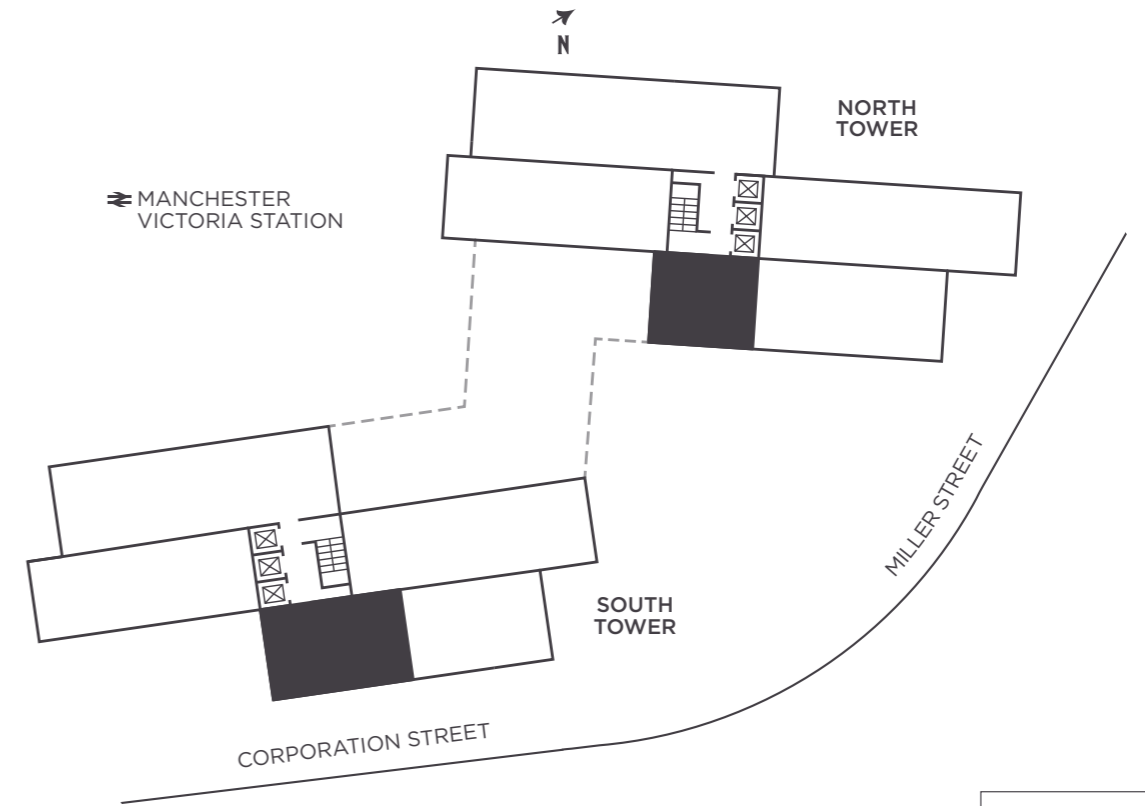

| ROOM                  | DIMENSIONS   |
|-----------------------|--------------|
| LIVING ROOM / KITCHEN | 4.20 x 5.60m |
| BEDROOM 1             | 3.41 x 3.89m |
| BEDROOM 2             | 2.80 x 3.39m |
| BEDROOM 3             | 2.80 x 4.17m |

